

Respirator Fit Testing



Features and Benefits

- Allows quantitative fit testing of any class, brand or size filtering-facepiece respirator
- Eliminates need to order or stock pre-probed masks from the respirator manufacturer
- Probe installation is fast and easy
- Inexpensive sampling probes are disposable

Fit Test Probe Kit Model 8025-N95

Use the TSI Model 8025-N95 Fit Test Probe Kit along with your PORTACOUNT® PRO and PRO+ Respirator Fit Testers to quantitatively fit test filtering-facepiece (disposable) respirators¹. The sampling probes work on all filtering-facepiece type respirators. In addition to determining if the mask is the right size, a successful quantitative fit test verifies that the employee has learned to properly bend the noseband and don the respirator.

The kit includes 500 lightweight disposable sampling probes and easy to use installation tools. It only takes a few seconds to puncture the mask, insert a probe and then press a push nut on from the other side. The PORTACOUNT PRO+ fit tester sample hose fits directly onto the exposed end of the sampling probe.



The PORTACOUNT PRO+ Respirator Fit Tester with probed P100 disposable respirator



Respirator Fit Testing

Note: If the probed filtering-facepiece cannot be sanitized, it should not be used to fit test another person. Also, the probed mask cannot be used in the workplace because the addition of the sampling probe compromises the integrity of the mask and voids the NIOSH approval.

¹Use the PORTACOUNT PRO or PRO+ fit tester to fit test NIOSH Series 100 and Series-99 disposable respirators. Use the PORTACOUNT PRO+ fit tester for fit testing Series-95 respirators.

For additional probes, please order Model 8025-N95R Refill Kit (contains 500 sampling probes and 500 push nuts).

PORTACOUNT PRO+ fit tester supplied with the same tool set that comes with the 8025-N95 Probe Kit and 100 probes.

TSI, the TSI logo, and PORTACOUNT are trademarks of TSI Incorporated.

Install a sampling probe for any filtering-facepiece in just seconds.



Step 1: Load a sample probe onto the piercing tool.



Step 2: Load a push nut onto the magnetic push nut tool.



Step 3: Use the piercing tool to puncture the respirator from the inside. Push the point through far enough to be seen from the other side.



Step 4: On the outside of the respirator, align the push nut tool over the end of the exposed point. Hold the tools in-line with each other and firmly push them together as far as possible.

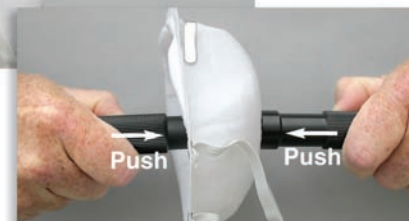

Step 5: Disengage the tools and inspect the sample port to make sure it's tightly pinched and will not leak.

The respirator is now ready for fit testing.



TSI Incorporated - 500 Cardigan Road, Shoreview, MN 55126-3996 USA
USA Tel: +1 800 874 2811 E-mail: info@tsi.com Website: www.tsi.com
UK Tel: +44 149 4 459200 E-mail: tsiuk@tsi.com Website: www.tsiinc.co.uk
France Tel: +33 491 95 21 90 E-mail: tsifrance@tsi.com Website: www.tsiinc.fr
Germany Tel: +49 241 523030 E-mail: tsigmbh@tsi.com Website: www.tsiinc.de
India Tel: +91 80 41132470 E-mail: tsi-india@tsi.com
China Tel: +86 10 8260 1595 E-mail: tsibeijing@tsi.com



TRUST. SCIENCE. INNOVATION.

Contact your local TSI Distributor or visit our website www.tsi.com for more detailed specifications.